

June 2026

Europa School Extension

Residents Newsletter

Keeping you informed and up to date on the Europa School Project.



Dear Resident,
We would like to welcome you to our first newsletter regarding the upcoming school extension project.

We would like to inform you that works associated with the project will be commencing from **15th June 2026**.

The school extension consists of a new 8-classroom teaching block, along with a new MUGA (Multi-Use Games Area) pitch and associated landscaping works.

Initial activities will include the mobilisation of the site, which will involve:

- Installation of temporary site fencing
- Establishment of the site compound
- Formation of a temporary haul road to facilitate access and deliveries.

These activities are necessary to safely set up the site prior to the main construction works. We will make every effort to minimise disruption to neighbouring residents; however, there may be some increase in activity during normal working hours while these initial works are carried out.

**MORGAN
SINDALL**
CONSTRUCTION

Meet The Team



Richard Weaving
Senior Project Manager
Richard.Weaving@morgan.sindall.com



Richard Walker
Site Manager
Richard.Walker@morgan.sindall.com



Liam Butler
Site Manager
Liam.Butler@morgan.sindall.com

Europa School Extension

Residents Newsletter

Keeping you informed and up to date on the Europa School.



Below is a plan of the new building, muga pitch and landscaping.

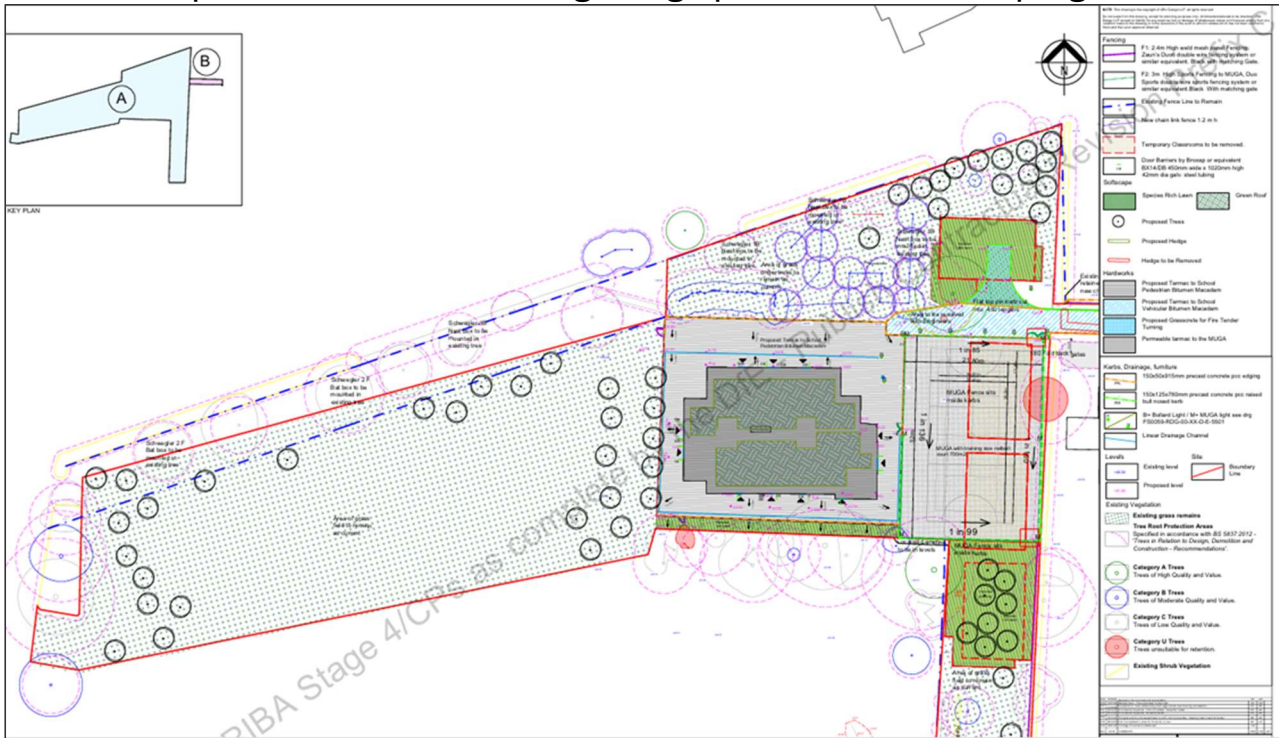

Below is our logistic plan that shows are site compound and haul road .

Logistics Plan – Section 1 Set Up

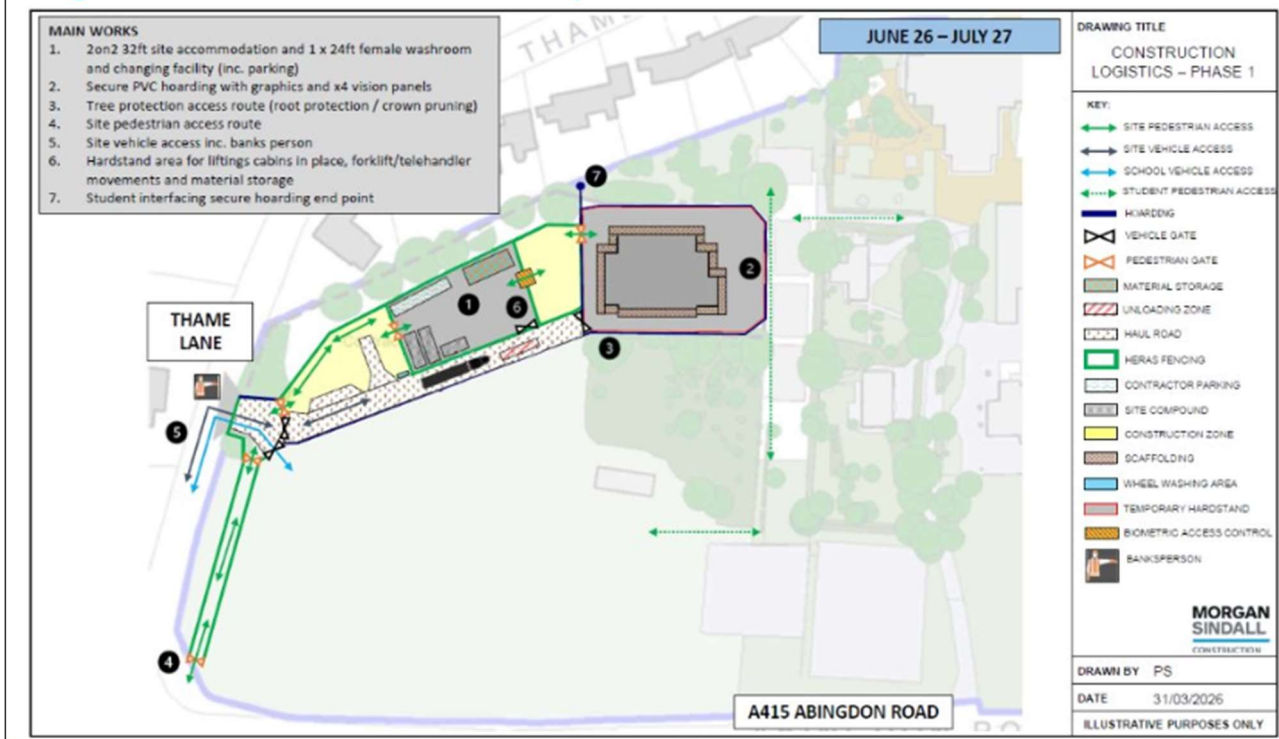

Should you have any questions or concerns, please do not hesitate to contact the project team.

We appreciate your patience and cooperation during this time.